

**Safety shut-off
for electric fuel pumps**

si 0016/A GB

MSI-PG 10.02

When installing an electric fuel pump instead of a mechanic pump, we recommend for safety reasons always to install a safety shut-off device.

The safety shut-off device shuts down the fuel pump even when the ignition is switched on if the engine does not run.

Pierburg provides a safety shut-off device as an installation kit.

Order no.: 4.05288.00

Scope of delivery

- 1 switch relay with counter connector, mounted connection lines and safety holder with 2A fuse.
- 1 ground cable for fuel pump
- 2 fitting bolts
- 6 different cable connectors
- 1 cable binder
- 1 installation instruction sheet

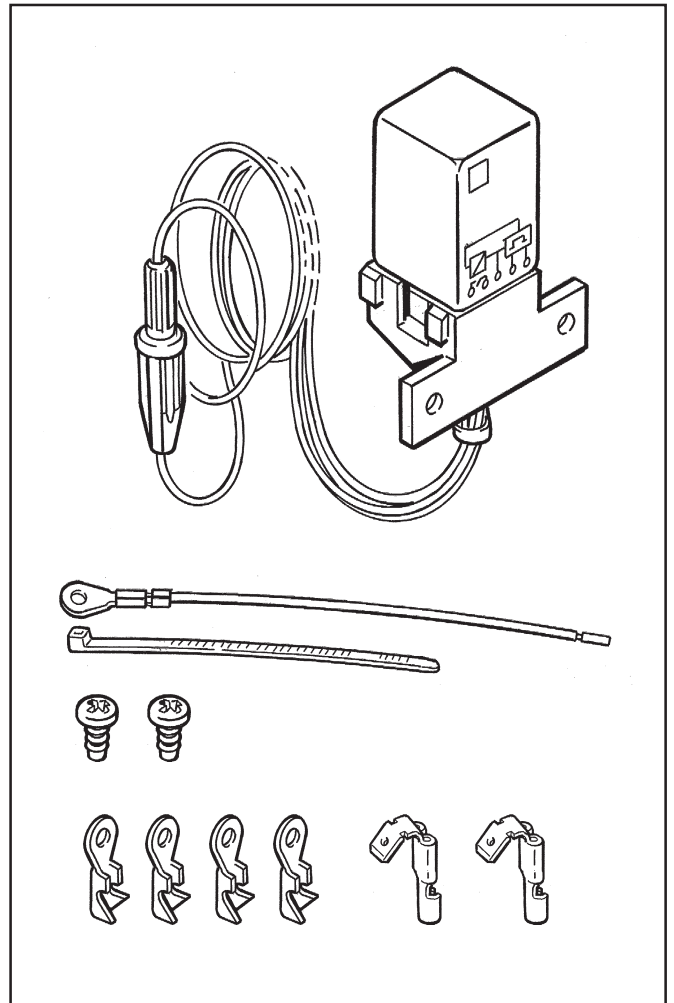

 For fitting, connection and function test, see → overleaf.

For changes with regard to part matching and spares, refer to the catalogue currently in effect.

Installation and connection

Only a qualified person may carry out this work.

- Switch of ignition and disconnect the battery.
- Fit relay with mating connector in a location protected against heat and spray water.
- Connect safety shut-off device as shown in the wiring diagram (see → Fig.). Refer to wiring diagram of the vehicle if necessary.
- Route cables so that they do not come into contact with hot parts of the engine.



Pumps with a higher rating must be fused according to their current consumption (up to max. 16A).
See → Fuel pump catalogue.

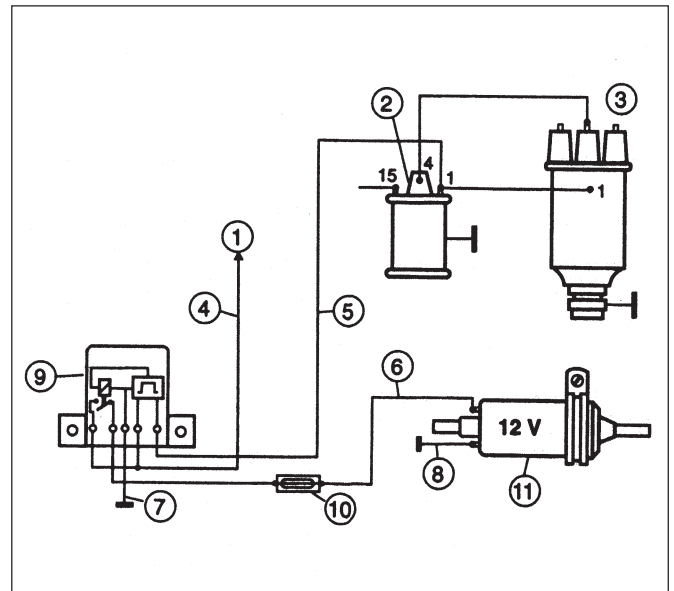

Wiring diagram

- | | |
|---------------------|----------------------------|
| 1 Terminal 15 (12V) | 7 brown |
| 2 Ignition coil | 8 brown |
| 3 Distributor | 9 Relay |
| 4 red | 10 Fuseholder with 2A fuse |
| 5 black | 11 electric fuel pump |
| 6 green | |

Function test

Precondition: Fuel lines and battery connected.

- Switch on ignition
Depending on the position of the distributor, the fuel pump may run for about 2 seconds.
- Start engine.
The fuel pump must run.
If the engine does not start, the pump will stop after about 2 seconds.
- Switch off the ignition with the engine running.
The fuel pump stops immediately.
- In the event of faults, repeat connection as shown in the wiring diagram.

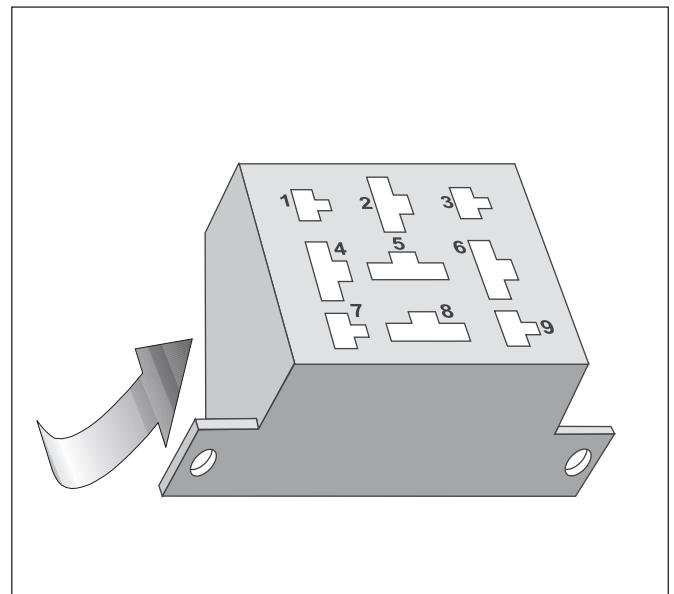

Assignments of relay socket

Socket No.	Cable Colour	Relay terminal No.
2	red	30
4	black	31b
5	brown	31
6	red	15
8	green	87



Lock cable from below.
A jumper is present between the red cables.